

Lug Cable ([Website](#))

Specifications

- 1. Raw Cable: #0/4 ~ #12 AWG
- 2. Rated Voltage: 600V
- 3. Operating Temperature: -40°C to 105°C
- 4. Reliable Crimping Technology

Wire Type: PVC, XLPE, Silicon

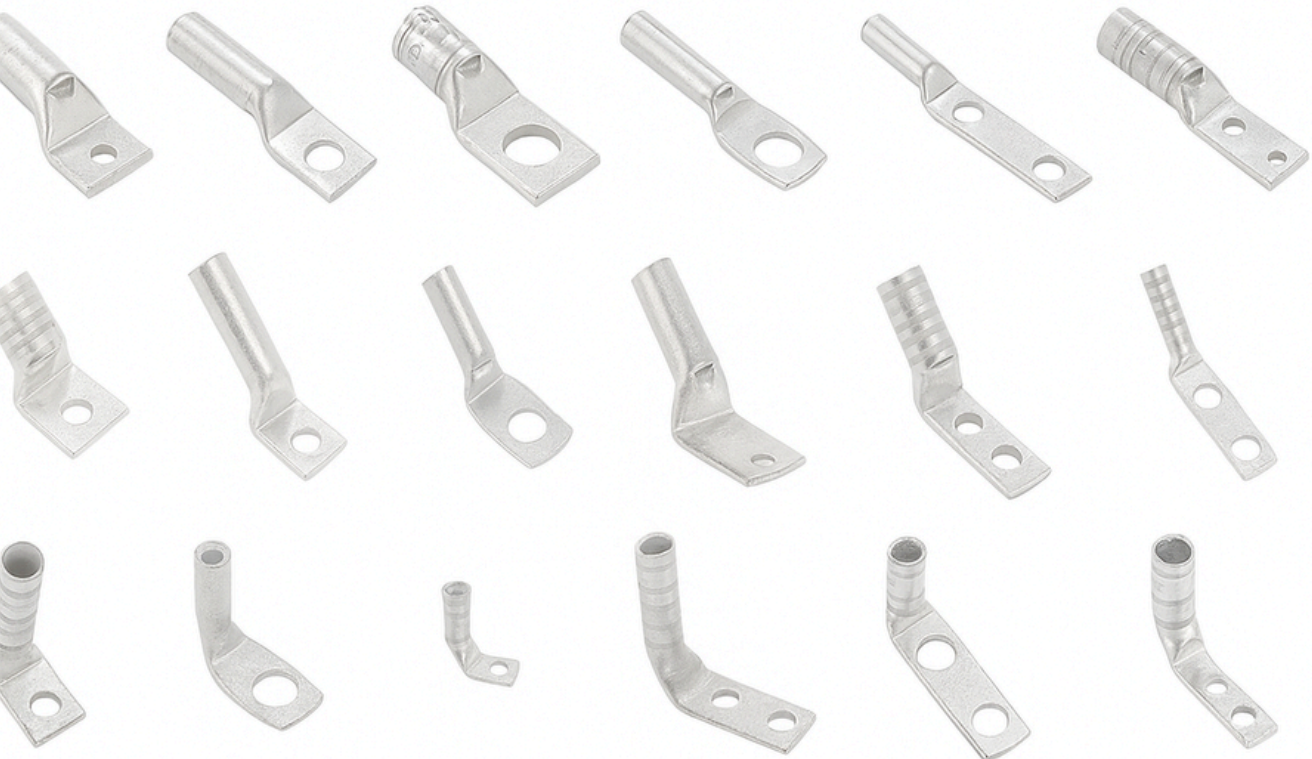

Cable Assembly	Power Cable	
Connectors	✓	
30A (10AWG)	✓	
50A (8AWG)	✓	
80A (6AWG)	✓	
120A (4AWG)	✓	
170A (2AWG)	✓	
230A (0AWG)	✓	
250A (00AWG)	✓	
360A (0000AWG)	✓	

Lug Cable ([Website](#))

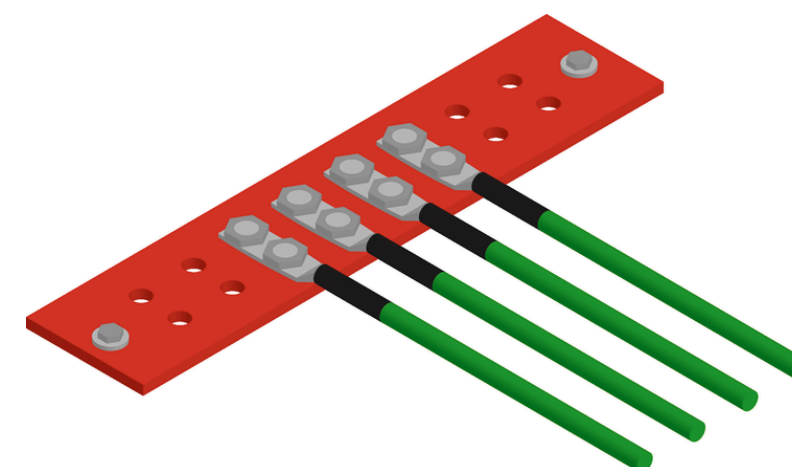

Device to Rack Cable (6 AWG)
Connects devices to the rack, with ESD protection for reliable operation and safety.



Rack to Ground Cable (2/0 AWG)
Connects the rack to ground, ensuring safe and reliable operation through ESD protection.

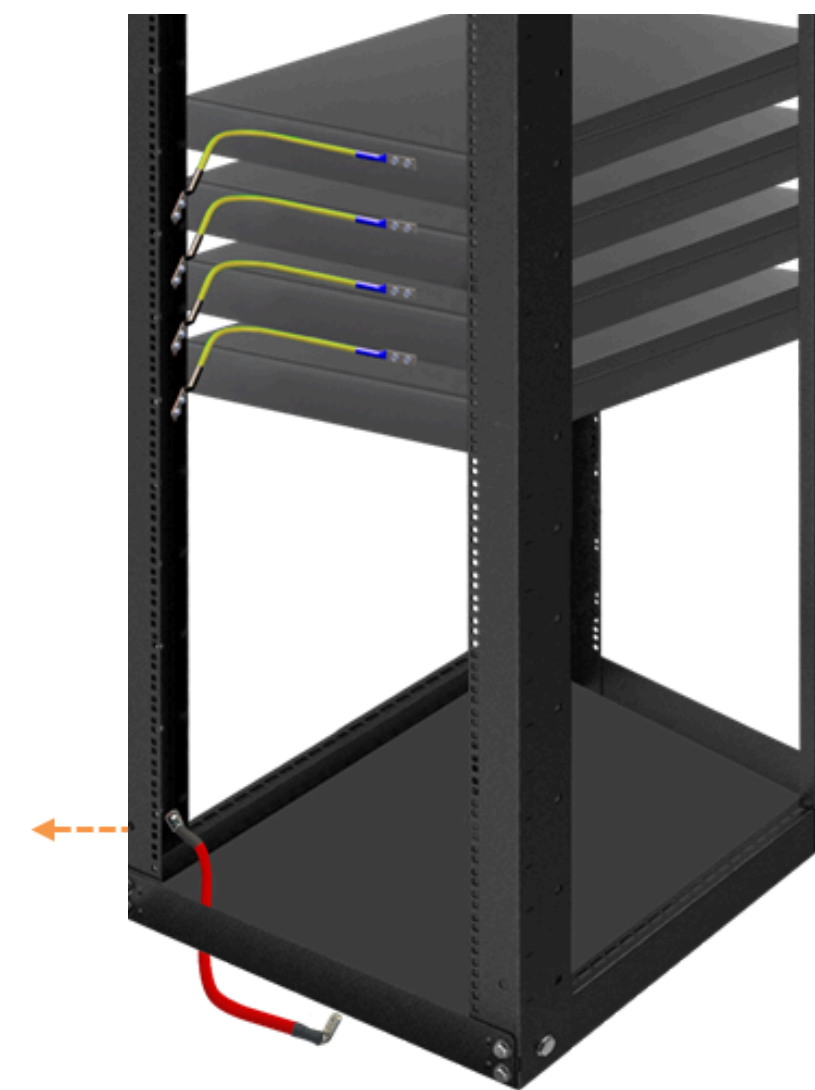

Power Cable and UQD

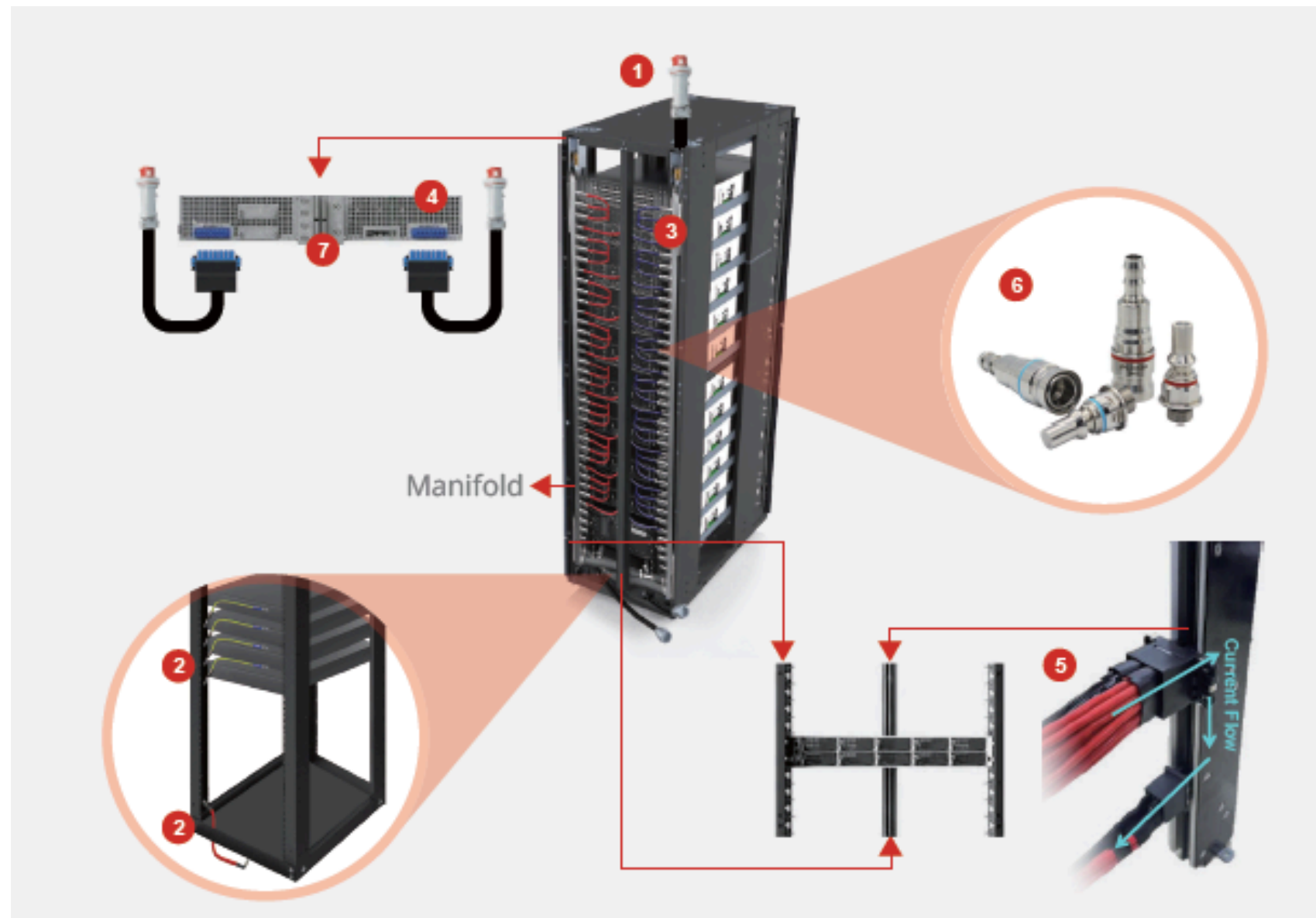

1 ORV3 AC Whip Cable



2 Lug Cable



3 Leakage Sensor Cable



4 ORV3 AC Input Cable



5 Busbar Clip Cable



6 Liquid Cooling Connector



7 Server Power Supply Unit

